



3 Olive Cottages, Mount Street, Shrewsbury, SY3 8QW

1 bedroom mid-terrace house—£175,000 Freehold

3 Olive Cottages, Mount Street, Shrewsbury, SY3 8QW

£175,000 Freehold—1 bedroom mid-terrace house

sales@cgpooks.co.uk

This charming cottage is tucked away in a quiet and secluded location with a south facing courtyard garden, whilst being just a few minute's walk from Theatre Severn, the many varied amenities of Frankwell and town centre

KEY FEATURES

- Living room with feature fireplace, exposed beams and window to front
- Separate fitted kitchen with integrated appliances and further exposed beams
- Good sized utility room to rear which also provides useful storage space
- Staircase from kitchen to landing where there is a large bathroom and double bedroom, which has built in wardrobes and views towards the town centre
- uPVC double glazed windows and gas fired central heating
- Block paved courtyard garden to front, which provides a lovely seating area
- Great location just a stones throw from the town centre, various excellent pubs and restaurants, as well as some fantastic independent businesses, such as a local store, bakery and health food shop

Cooper Green Pooks
3 Barker Street
Shrewsbury
SY1 1QF

www.cgpooks.co.uk
sales@cgpooks.co.uk
01743 276666



Coopergreenpooks.co.uk

Ground Floor

Approx. 24.9 sq. metres (268.0 sq. feet)

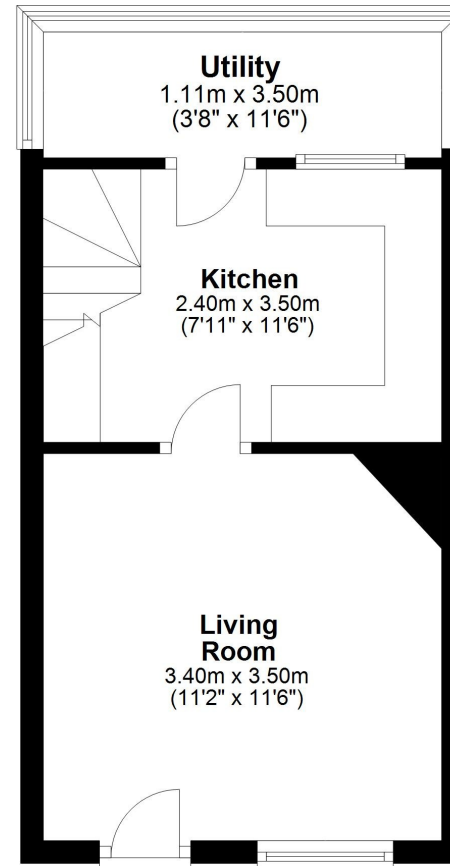

First Floor

Approx. 21.7 sq. metres (233.8 sq. feet)

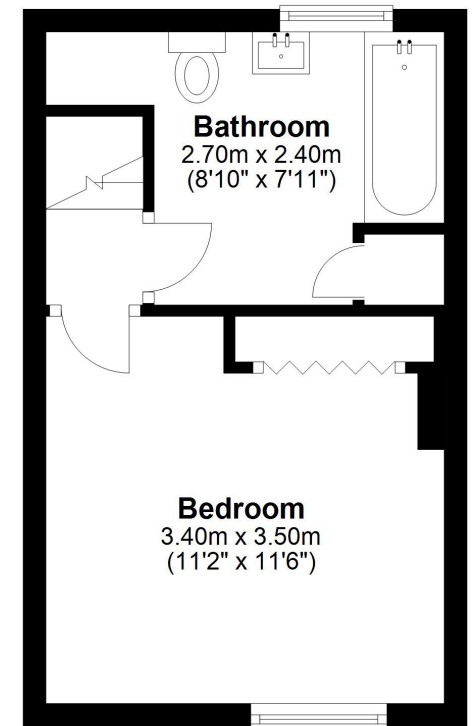

Total area: approx. 46.6 sq. metres (501.8 sq. feet)





3 Olive Cottages, Mount Street, Shrewsbury, SY3 8QW

£175,000 Freehold—1 bedroom mid-terrace house

sales@cgpooks.co.uk

rightmove

onTheMarket.com

RICS
Regulated by RICS



BOUNDARIES NOT CONFIRMED

Tenure	Freehold
Local Authority	Shropshire Council
Council Tax	Band A
EPC Band	TBC
Services	All mains services are connected

Expert mortgage advice available

3 Barker St, Shrewsbury SY1 1QF

Cooper Green Pooks
01743 276666

Your home may be repossessed if you do not keep up repayments on your mortgage.

There may be a fee for mortgage advice. The actual amount you pay will depend upon your circumstances. The fee is up to 1% but a typical fee is 0.3% of the amount borrowed.

3 Olive Cottages, Mount Street, Shrewsbury, SY3 8QW

Coopergreenpooks.co.uk

£175,000 Freehold—1 bedroom mid-terrace house

sales@cgpooks.co.uk

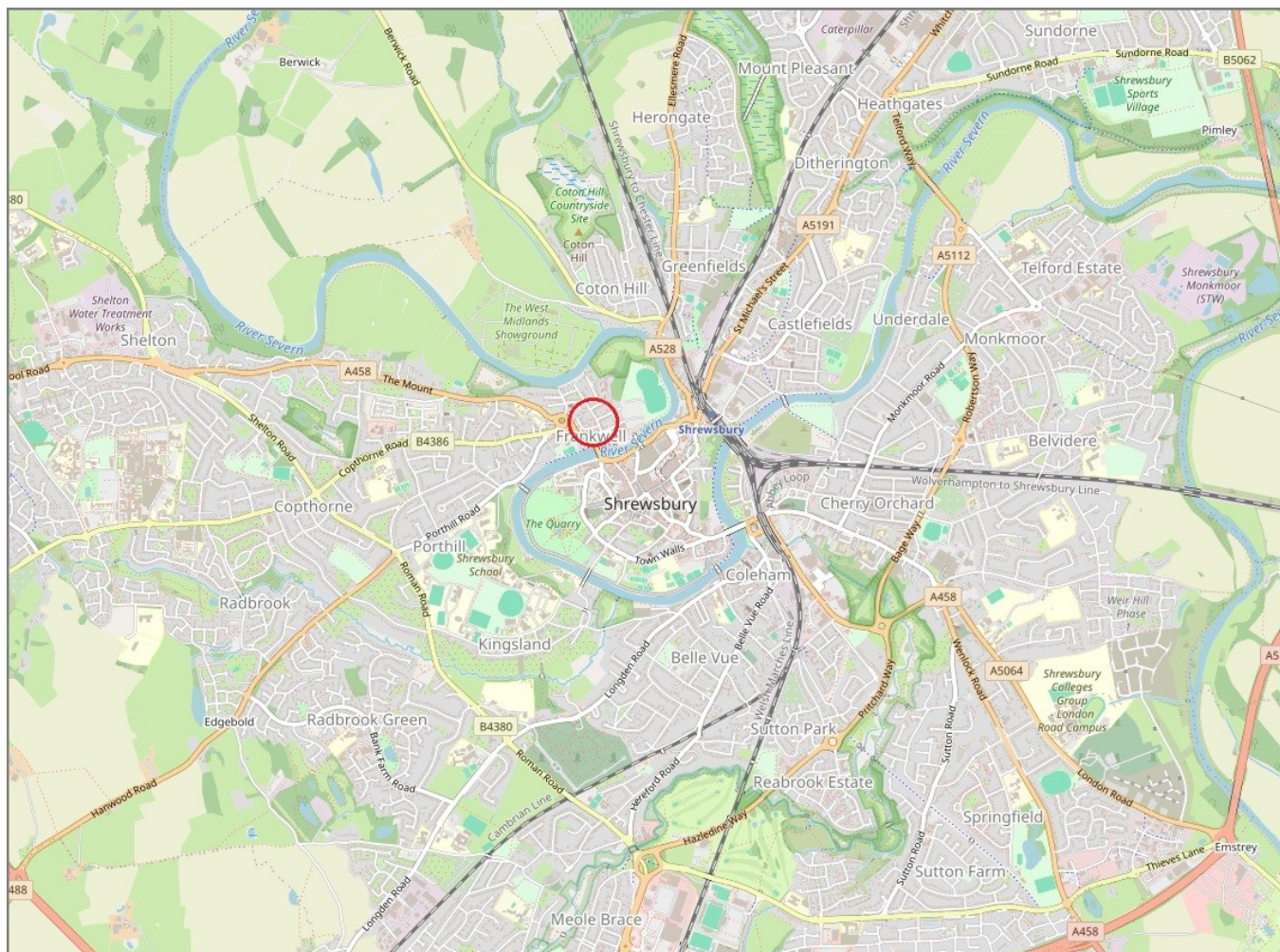

IMPORTANT NOTICE: Cooper Green Pooks for themselves and for the lessors or vendors of this property whose agents they are give notice that: 1 No appliances, services or service installations have been tested and no warranty as to suitability or serviceability is implied. Any prospective purchaser or lessee is advised to obtain verification from their surveyor or solicitor. 2. The particulars are set out as a general outline only for the guidance of the intended purchasers or lessees and do not constitute, nor constitute part of, an offer or contract. 3. All descriptions, reference to condition and necessary permissions for use and occupation and other details are given in good faith and are believed to be correct but any intending purchasers or lessees should not rely on them as statements or representation of fact but satisfy themselves by inspection or otherwise as to the correctness of each of them. 4. No person in the employment of Cooper Green Pooks has any authority to make or give any representation or warranty whatsoever in relation to this property. 5. All rentals and prices are quoted exclusive of Stamp Duty, legal and surveyors fees and any other associated purchasers or lessees costs. 6. Floor plans are indicative only and should not be relied on. 7. The plan showing the boundary of the property is indicative only and has not been checked against the legal title so should not be relied on. 8. All dimensions, floor areas and site areas are only approximate and should not be relied on. Dimensions are generally maximum room dimension.